

# ASAP

built to protect

asapwalls.com  
info@asapwalls.com  
410-200-2001

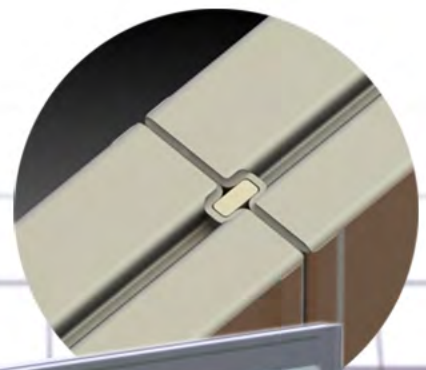
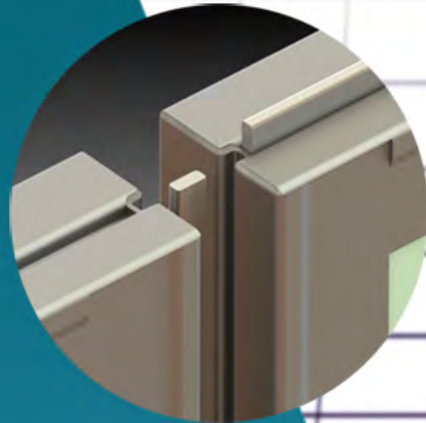

affordable triple threat wall  
FORCED ENTRY  
BALLISTIC  
BLAST



Effective low cost protection  
for sensitive infrastructures

**ASAIP**

s3-Wall Fence

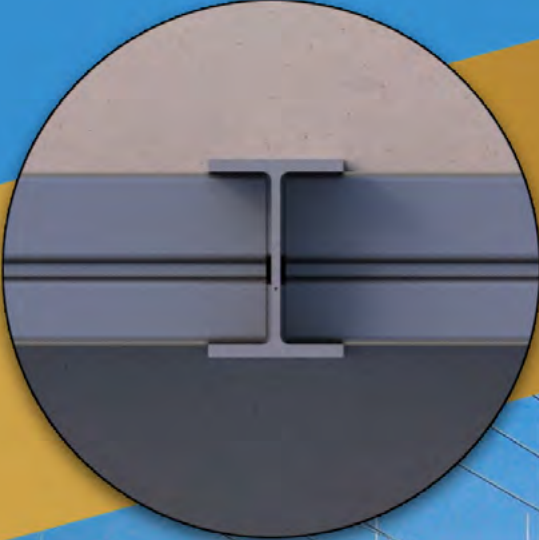

Standard I-Beams  
Cemented into the ground



**ASA/P**

safe rooms - low cost and easy to install

install a place  
to escape against

FORCED ENTRY  
BALLISTIC ATTACK  
EXPLOSION / STORM

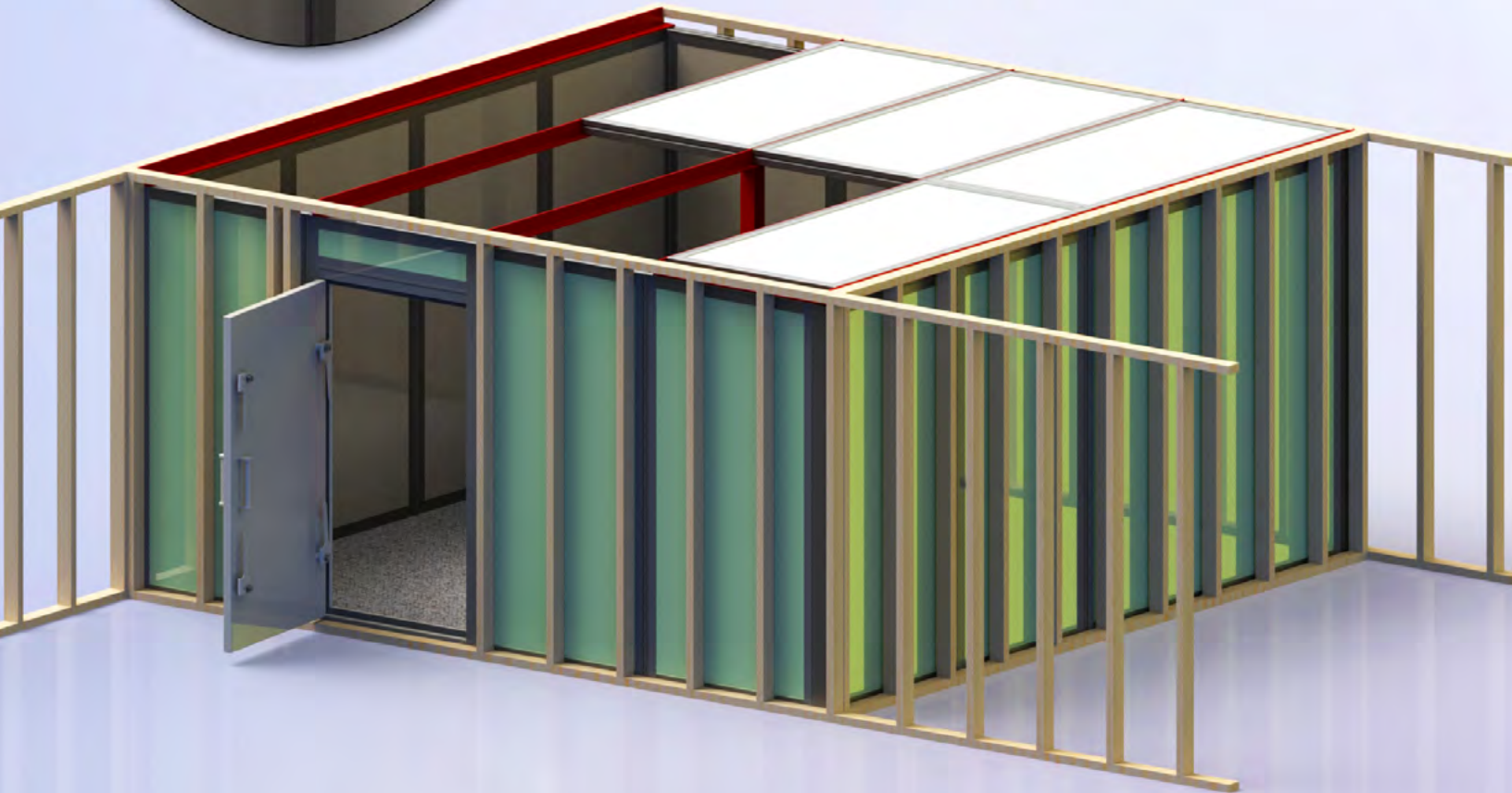
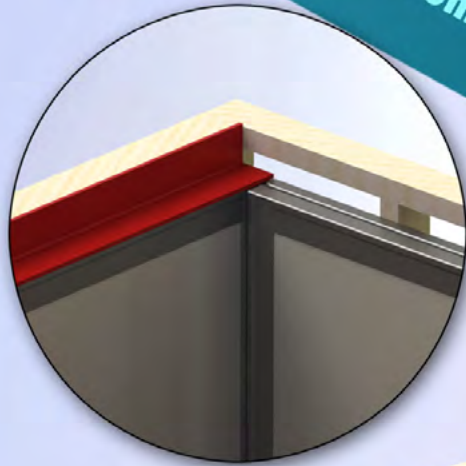

[asapwalls.com](http://asapwalls.com)

[info@asapwalls.com](mailto:info@asapwalls.com)

410-200-2001

s3-Wall

## Specifications

Standard panel heights

Special height

Standard panel width

Special width

Panel thickness

Panel weight

Ballistic certification

Blast certification

Forced Entry/Ballistic certification

8mm shear bar

Appearance

8 ft, 10 ft, 12 ft

Available on request

4 ft

Available on request

3 1/4 in

18 lbs/square foot

UL 752 Level 8

11 psi overpressure and 89 msec

15 min / dif. caliber multiple shots

For horizontal and vertical stacking

Many colors and finishes

[asapwalls.com](http://asapwalls.com)

[info@asapwalls.com](mailto:info@asapwalls.com)

410-200-2001